

# BASIC PRO-SERIES WORKBENCH

## SECTION #1

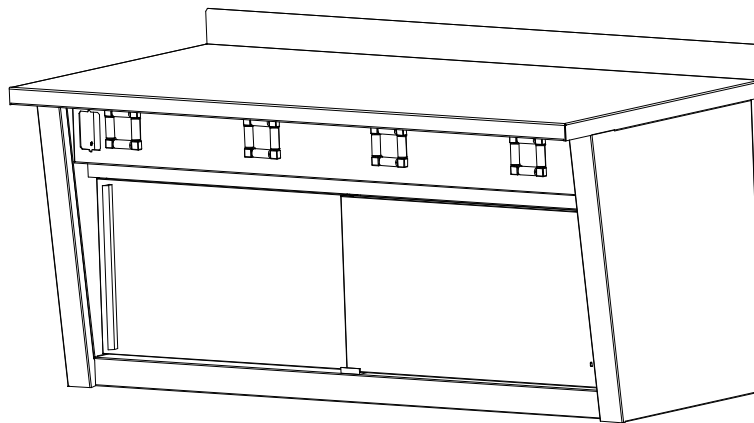
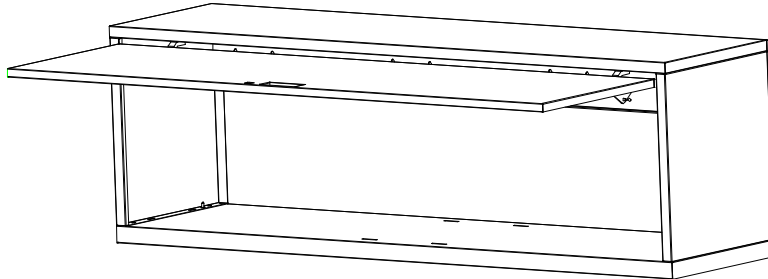

### CONTENTS

Basic Pro-Series.....	2
Roller Bearings.....	11
Lift Cabinet.....	12
Continuous Pro-Series.....	14

**IMPORTANT - PRODUCT LIABILITY INFORMATION** Read all instructions before proceeding with installation. Vital product information pertaining to proper set-up and cautions are included. Failure to follow these instructions may result in personal injury and/or property damage.

**RETAIN THIS MANUAL FOR FUTURE REFERENCE**

**NOTICE:** Borroughs Corporation extends to the original purchaser from the date of purchase, a 5 year limited warranty against manufacturing defects in material and workmanship. If a Borroughs product fails to perform because of a manufacturing defect, Borroughs will examine it. If found defective, it will be repaired at our option. This warranty applies only to Borroughs products acquired directly from Borroughs Corporation or from Authorized Borroughs Dealers. This warranty does not apply to any product which has been subject to misuse, negligence, or accident; has been damaged in shipment, storage, or installation; has been misapplied or has been modified or repaired by unauthorized persons or been repaired with non-standard Borroughs replacement parts. This warranty specifically excludes claims for indirect, incidental, or consequential damages arising in any way from a product defect. This warranty is exclusive, and exists in lieu of all other warranties, either express or implied. This warranty gives you specific legal rights; you may also have other rights which may vary from state to state. To obtain warranty service, contact your Borroughs Selling Dealer. You must make a written claim. Provide a copy of your purchase record and a written description of the warranty problem with your claim. If you are unable to contact your dealer, contact: Borroughs Corporation, Customer Service Manager, 3002 N. Burdick Street, Kalamazoo, MI 49004-3483



3002 N. BURDICK ST. ▪ KALAMAZOO, MI 49004-3483  
 800-748-0227 ▪ FAX: 269-342-4161 ▪ [www.borroughs.com](http://www.borroughs.com)

**09-50679-00**  
**November 2004**

FOR STEPS 1-3, HARDWARE NEED ONLY BE FINGERTIGHTENED

**TOOLS REQUIRED:** PHILLIPS HEAD SCREWDRIVER, ADJ WRENCH, FLAT HEAD SCREWDRIVER, CORDLESS DRIVER WITH PHILLIPS ATTACHMENT, TAPE MEASURE

**\*REMOVE ALL ITEMS FROM CARTON AND CHECK AGAINST THE FOLLOWING LIST:**

**\*PARTS LIST – BASIC UNIT\***

ITEM	DESCRIPTION	REQ'D
1	BENCH TOP	1
2	LH LEG NO HOLES	1
3	RH LEG NO HOLES	1
4	LH LEG FILLER	1
5	RH LEG FILLER	1
6	BASE SHELF	1
7	BACK STOP CHNLS	1
8	BENCH DOORS	2
9	DOOR TRACK	1
10	TRACK COVER	1
11	BACKSPLASHES	1
12	FRONT FACE BRKT	1

**\*REMOVE ALL ITEMS FROM THE HARDWARE PACK AND CHECK AGAINST THE FOLLOWING LIST:**

ITEM 13  
10-24 KEPS NUT  
SCREW  
(3) REQ'D



ITEM 14  
PNHD TH 10-24 x 3/8  
(3) REQ'D

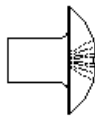

ITEM 15  
1/4 FLAT WASHER  
(24) REQ'D

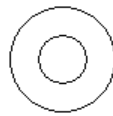

ITEM 16  
1/4-20 KEPS NUT  
(12) REQ'D



ITEM 17  
1/4-20X5/8 GD5 HX HD  
(12) REQ'D

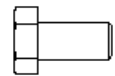

ITEM 18  
DBLE CHNL DOOR GUIDE  
(1) REQ'D

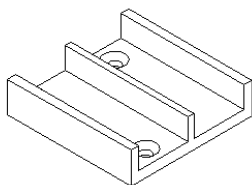

ITEM 19  
8-32 x 1/4 FLHD MS  
(2) REQ'D

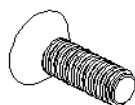

ITEM 20  
KEPS NUT 8-32  
(2) REQ'D



ITEM 21  
1-5/8 X 1-5/8 SQ WASHER  
(4) REQ'D

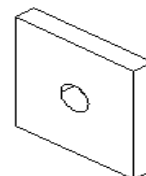

ITEM 22  
3/8-16 X1-1/4 BOLT  
(4) REQ'D

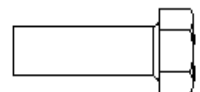

ITEM 23  
5/16-18 KEPS NUT  
(12) REQ'D

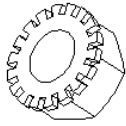

ITEM 24  
5/16-18 X 5/8 HXHD BOLT  
(12) REQ'D

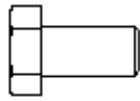

ITEM 25  
DOOR HANDLE 15IN  
(2) REQ'D

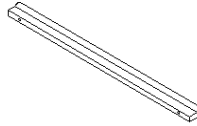

ITEM 26  
ROLLER WHEEL  
(4) REQ'D



ITEM 27  
10-24 ROLOK  
(12) REQ'D

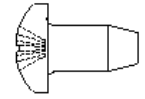

ITEM 28  
5/8 OFFSET WHEEL BRKT  
(2) REQ'D

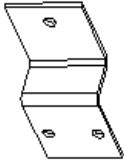

ITEM 29  
STRAIGHT WHEEL BRKT  
(2) REQ'D

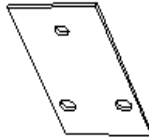

ITEM 30  
M4-7 X 8MM TRHD  
(4) REQ'D

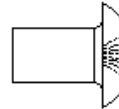

ITEM 31  
8-32 X 5/16 PNHD PHIL  
(4) REQ'D



ITEM 32  
1/4-20 x 3/4 Hes Head SFS  
(4) REQ'D

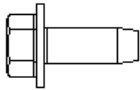

ITEM 33  
#14 x 3/4 Hex Head SDS  
(1) REQ'D

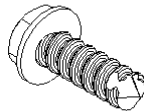

**STEP 1: LEG ASSEMBLY**

Place a bench top (Item 1) on a flat surface with the four support angles facing up. Fasten LH and RH legs (Items 2 & 3) to the outside angles using (10) 5/16-18 x 5/8 hex head bolts (Item 24) and (10) 5/16-18 keps nut (Item 23). If your bench has an overhang then move the leg with holes in 12" to the inside support angle. Do not place bolt in hole closest to front of bench until leg fillers are in place. Next, place LH and RH leg fillers (Items 4 & 5) to the inside of the legs as shown in (Figure 1.). Use (1) 5/16-18 x 5/8 cap screw (Item 24) and (1) 5/16-18 keps nut (Item 23) per filler. Do not tighten fasteners.

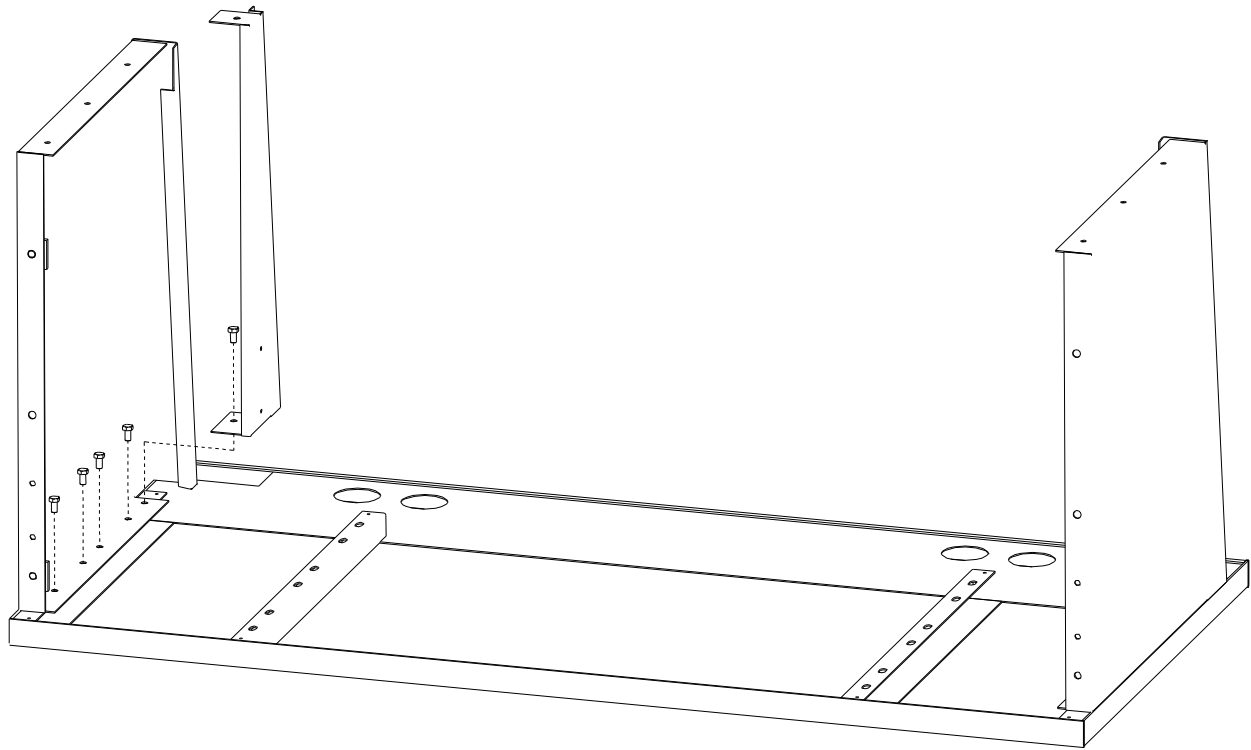

**Figure 1.**

**STEP 2: BASE SHELF ASSEMBLY**

Place the base shelf (Item 6) between the leg fillers and the leg (Figure 2.) on both sides. Fasten base shelf to legs and fillers by using (8) ¼-20 x 5/8 cap screws (Item 17), (16) ¼ flat washers (Item 15), & (8) ¼-20 keps nuts (Item 16). Next, position and fasten back stop chnl into place with (4) ¼-20 x 5/8 cap screws (Item 17), (8) ¼ flat washers (Item 15), & (4) ¼-20 keps nuts (Item 16). Do not tighten fasteners at this point.

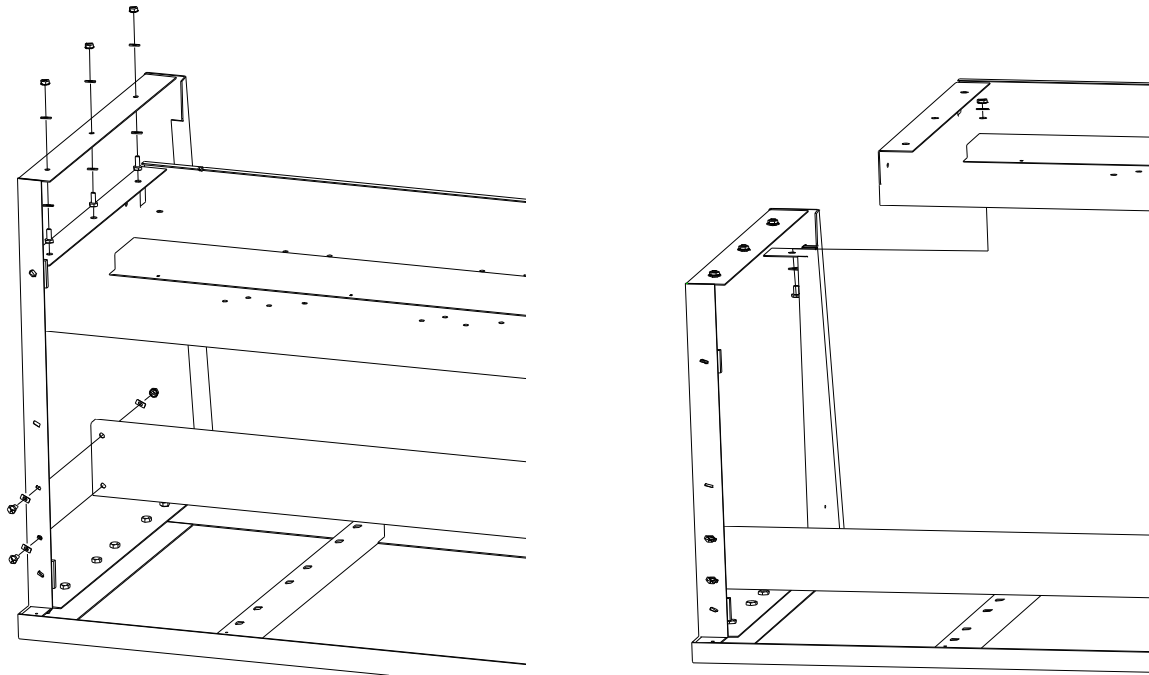
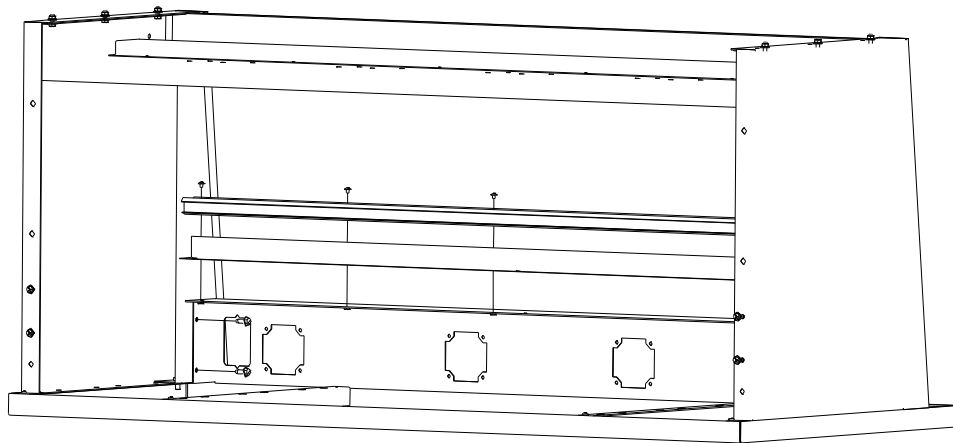

**Figure 2.**

**IF INSTALLING ROLLER BEARINGS THEN SKIP TO SECTION 2 BEFORE GOING TO STEP 3**

**STEP 3: FRONT FACE / DOOR TRACK**

Place the front face (Item 12) in-between the leg fillers as is shown in (Figure 3). Line up the holes in the leg fillers with the holes on the ends of the front face and fasten tight with (4) 1/4-20 x 3/4 hex head TFS (Item 32). Next, fasten the front edge of the front face to the top using (1) #14x3/4 hex head SDS (Item 33) through the hole in the front face. Place the track cover (Item 10) on the front face lining up the three holes, then place the track (Item 9) on top of the track cover keeping the three holes lined up. Using (3) #10-24 x 3/8 Truss Hd Phil (Item 14) and (3) #10-24 keps nut (Item 13) fasten track & track cover to front face.



**Figure 3.**

**STEP 4: SQUARE AND TIGHTEN**

Measure the distance from the back of the leg to the edge of the top. This distance needs to be 1/8" smaller than the depth of the uni-strut being used to mount unit to the wall (Ex. Set distance to 1-1/2" if using 1-5/8" uni-strut). Next measure the distance from the outside of the leg to the side edge of the top and make sure they are equal to ensure a square unit. **NOTE: IF BUILDING A 10FT BENCH WITH 24" CENTER SHELF SET DISTANCE FROM OUTSIDE OF LEG TO SIDE EDGE OF BENCH TO 12-1/16"**. Once both legs have been measured and set for square then tighten the (12) 5/16-18 x 5/8 cap screws (Item 24) that attach the top to the legs. Once those have been tightened everything else may be tightened at this time. See (Figure 4).

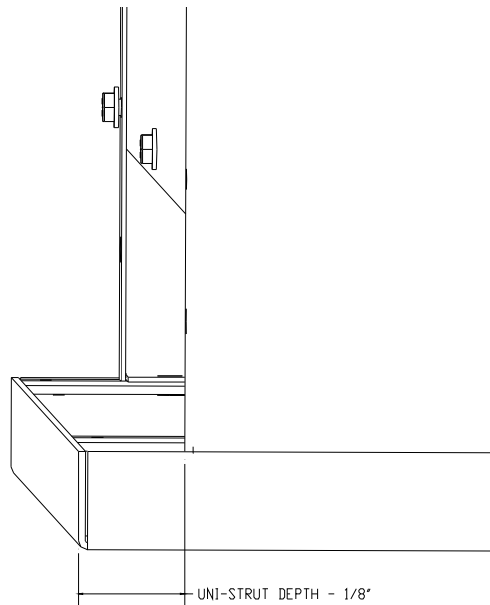
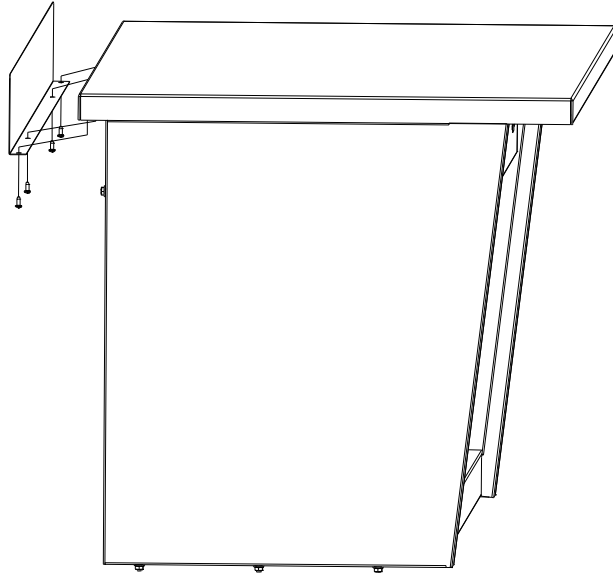

**Figure 4.**

**IF INSTALLING LIFT CABINET THEN SKIP TO SECTION 3 BEFORE GOING TO STEP 5**

**STEP 5: ATTACH BACKSPLASH**

Remove protective film from backsplash and fasten to back of bench top using (4) 10-24 rolok screws (Item 27). See (Figure 5).



**Figure 5.**

**STEP 6: MOUNT TO WALL**

Set bench upright on floor. Cut (2) pieces of uni-strut to nominal length of bench. Attach first piece of uni-strut to wall 12" above the floor. Attach second piece of uni-strut to wall 30" above floor. For proper alignment it's very important that the two pieces of uni-strut are mounted 18" center to center. Make sure uni-strut is parallel to floor and parallel to each other. Place (2) spring loaded uni-strut nuts in the top and bottom uni-strut that will line up with the holes in the legs for mounting. Using (4) 1-5/8 x 1-5/8 sq washers (Item 21) and (4) 3/8-16 x 1-1/4" cap screws (Item 22) attach unit to wall. Keep fasteners loose until bench is in desired location and then tighten. See (Figure 6)

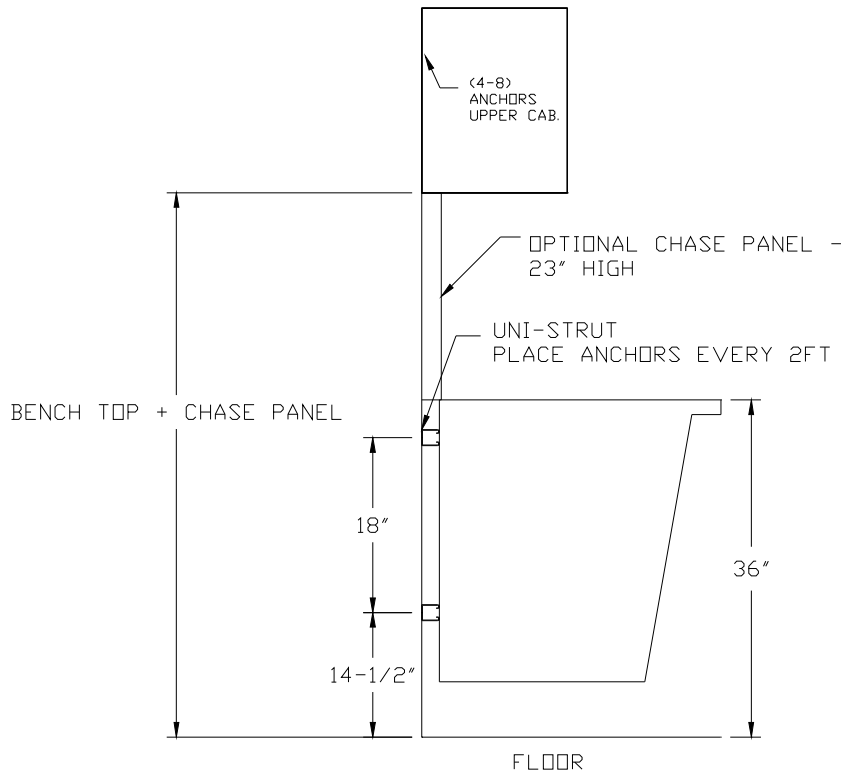

**Figure 6.**

**NOTE: IF A BENCH TOP HEIGHT OF 36" IS NOT WANTED THEN ADJUST BOTTOM UNI-STRUT ACCORDLYING BUT KEEP 18" DISTANCE BETWEEN THE TWO UNI-STRUTS**

**IF YOU'RE ASSEMBLING A 2<sup>nd</sup> PART 10FT WORK BENCH GO TO SECTION #4 BEFORE STARTING STEP #7**

**STEP 7: DOOR ASSEMBLY**

Attach the handles (Item 25) to the doors using (2) M4-.7 x 8mm phil truss hd screws (Item 30) per door. Fasten (2) 5/8 offset wheel brackets (Item 28) to the front door using (4) 10-24 rolok screws (Item 27), make sure handle is on the right hand side. Then fasten (2) straight wheel brackets (Item 29) to the back door using (4) 10-24 rolok screws (Item 27), make sure when brackets are attached that handle is on the left hand side. Assemble (2) roller wheels (Item 26) to each door using (2) 8-32 x 5/16" pnhd phil screw (Item 31). See (Figure 7).

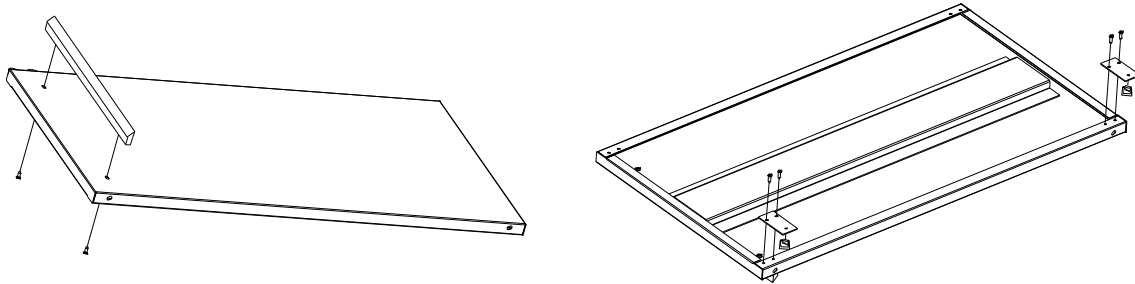

**Figure 7.**

**STEP 8: MOUNT DOORS**

Hang back door first by tilting door outward at bottom and setting on the back track. Then hang the front door by tilting door outward at the bottom and setting on the front track. Once both doors are hung then push both doors to one side and slide in (1) double channel door guide (Item 18). Use (2) 8-32 x 3/4 flat hd screw (Item 19) and (2) 8-32 keps nut (Item 20) to fasten door guide. See (Figure 8).

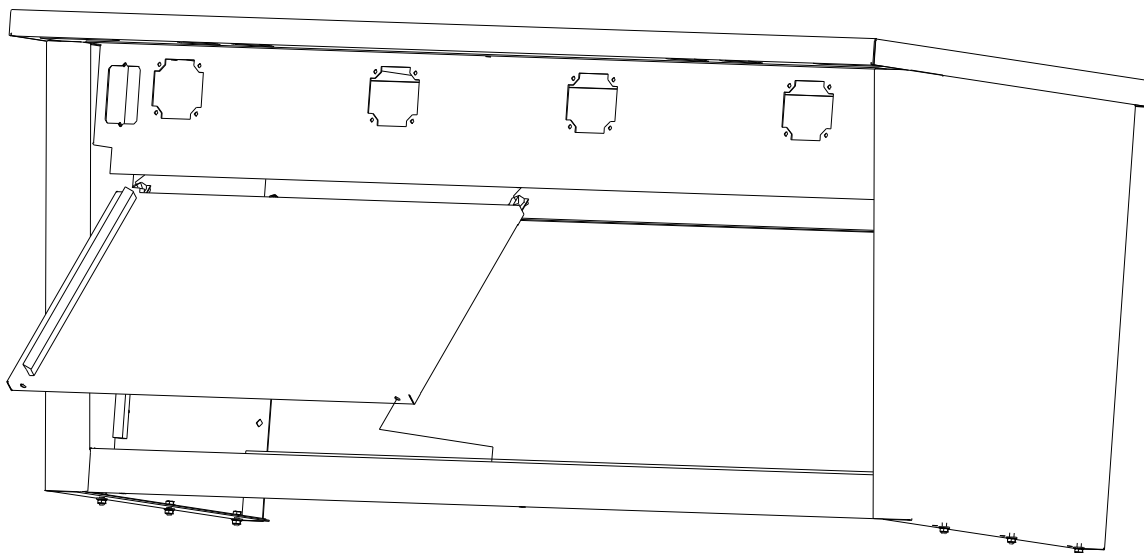

**Figure 8.**

# ROLLER BEARING ASSEMBLY

## SECTION #2

FOR STEP 1, HARDWARE NEED ONLY BE FINGERTIGHTENED

TOOLS REQUIRED: PHILLIPS HEAD SCREWDRIVER

\*REMOVE ALL ITEMS FROM CARTON AND CHECK AGAINST THE FOLLOWING LIST:

### \*PARTS LIST – ROLLER BEARING\*

\*REMOVE ALL ITEMS FROM THE HARDWARE PACK AND CHECK AGAINST THE FOLLOWING LIST:

ITEM 1  
PNHD TH 10-24 x 1/4  
(4) REQ'D

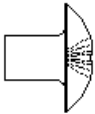

ITEM 2  
NYLON ROLLER  
(4) REQ'D

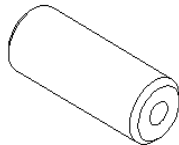

ITEM 3  
ROLLER GUIDE MTG BLOCK  
(4) REQ'D

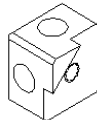

ITEM 4  
2-9/16" ROD  
(4) REQ'D

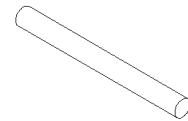

#### STEP 1: ROLLER BEARING ASSEMBLY

Prior to Step 3 in the first section, attach the (4) roller guide mtg blocks (Item 3) to the front face. Use (4) 10-24x1/4 pnhd screws to attach the mounting blocks, DO NOT TIGHTEN. Slide (1) rod (Item 4) into (1) nylon roller (Item 2) and then slide the rod into hole in mounting block then slide the other end into the corresponding hole in opposite mounting block. Make sure that the tabs on the mounting blocks are facing towards the opening. Repeat for all four rollers. See (Figure 9).

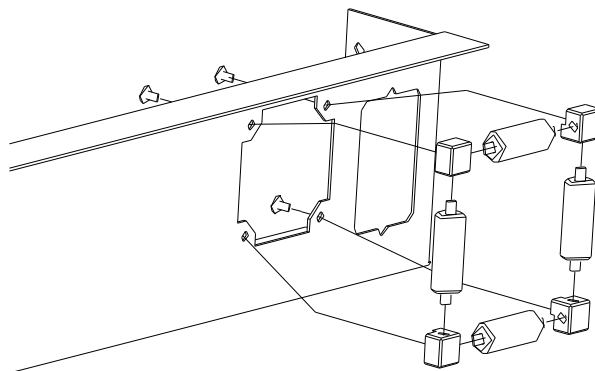

Figure 9.

#### STEP 2: TIGHTEN ROLLER ASSEMBLY

Once all four roller bearings are installed then tighten all four screws.

# LIFT CABINET ASSEMBLY

## SECTION #3

**FOR STEP 1, HARDWARE NEED ONLY BE FINGERTIGHTENED**

**TOOLS REQUIRED:** PHILLIPS HEAD SCREWDRIVER, ADJ WRENCH

**\*REMOVE ALL ITEMS FROM CARTON AND CHECK AGAINST THE FOLLOWING LIST:**

### \*PARTS LIST – LIFT CABINET\*

ITEM	DESCRIPTION	REQ'D
1	BOTTOM ANGLE LATCH	1
2	LIFT SIDE PAN W/HOLES	1
3	LIFT SIDE PAN NO HOLES	1
4	LIFT CABINET FACE	1

**\*REMOVE ALL ITEMS FROM THE HARDWARE PACK AND CHECK AGAINST THE FOLLOWING LIST:**

ITEM 5  
¼ FLAT WASHER  
(12) REQ'D

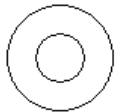

ITEM 6  
¼-20 KEPS NUT  
(6) REQ'D



ITEM 7  
¼-20X5/8 GD5 HX HD SCREW  
(6) REQ'D

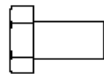

ITEM 8  
10-24 ROLOK  
(2) REQ'D

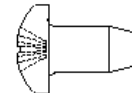

ITEM 9  
SNAP IN MAGNET  
(8) REQ'D

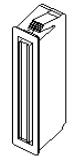

#### **STEP 1: ATTACH LEGS TO TOP**

Prior to Step 5 in the first section, attach (1) lift side panel w/holes (Item 2) to the leg on the side where the over hang is. The edge of panel with rectangular holes goes to the front. Use (4) 1/4-20x5/8 hex head screws (Item 7), (4) ¼-20 keps nuts (Item 6) & (8) ¼ flat washers (Item 5) to attach the panel, **DO NOT TIGHTEN**. Set (1) lift side panel with no holes (Item 3) on the top support at the edge of the bench top with rectangular holes towards the front. Use (2) 1/4-20x5/8 hex head screws (Item 7), (2) ¼-20 keps nuts (Item 6) & (4) ¼ flat washers (Item 5) to attach the panel, **DO NOT TIGHTEN**. Measure the distance from back edge of the bench top to the back of leg. Use that dimension to set lift side panels flush with the legs on the back side. Also, make sure outer panel with no holes is flush with the side edge of bench top. See (Figure 10). Once panels are located flush with the legs tighten hardware.

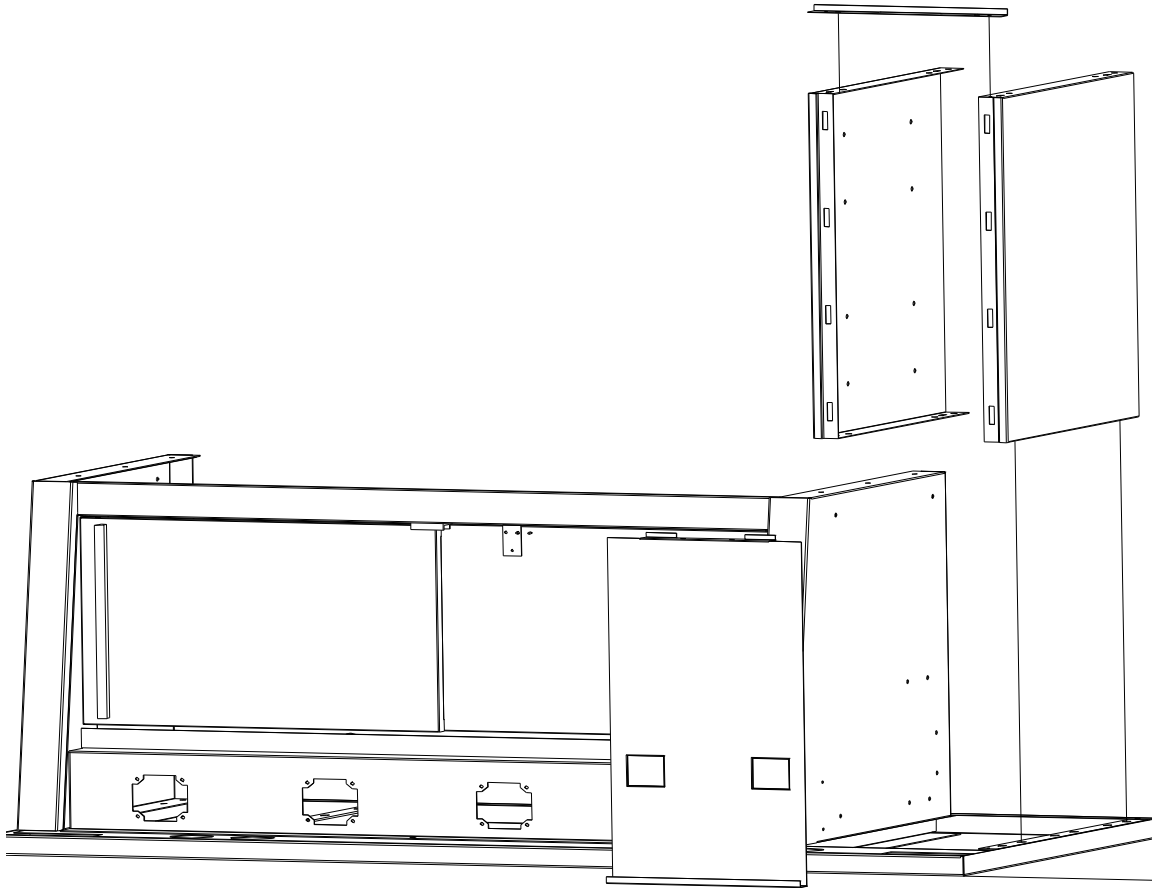

**Figure 10.**

**STEP 2: ASSEMBLE BOTTOM LATCH ANGLE**

Once both side panels are tightened then attach (1) bottom angle latch (Item 1) to the underside of the side panels shown in Figure 2. Use (2) 10-24 rolok screws (Item 8) to fasten bottom angle. If door fits too tight than loosen 10-24 rolok screws and pull side panels apart to widen distance and then re-tighten.

# 10 FEET PRO-SERIES ASSEMBLY

## SECTION #4

**FOR STEPS 1&2, HARDWARE NEED ONLY BE FINGERTIGHTENED**

**TOOLS REQUIRED:** PHILLIPS HEAD SCREWDRIVER, ADJ WRENCH, FLAT HEAD SCREWDRIVER, CORDLESS DRIVER WITH PHILLIPS ATTACHMENT, TAPE MEASURE

**\*REMOVE ALL ITEMS FROM CARTON AND CHECK AGAINST THE FOLLOWING LIST:**

### \*PARTS LIST – 10FT W/CENTER SHELF UNIT\*

ITEM	DESCRIPTION	REQ'D
1	CENTER DOOR	1
2	CENTER BASE SHELF	1
3	BACK STOP CHNL	1
4	24" FRONT FACE BRKT	1

**\*REMOVE ALL ITEMS FROM THE HARDWARE PACK AND CHECK AGAINST THE FOLLOWING LIST:**

**ITEM 5**  
¼ FLAT WASHER  
(8) REQ'D

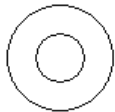

**ITEM 6**  
¼-20 KEPS NUT  
(4) REQ'D



**ITEM 7**  
¼-20X5/8 GD5 HX HD SCREW  
(4) REQ'D

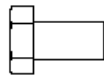

**ITEM 8**  
¼-20 x ¾ Hes Head SFS  
(4) REQ'D

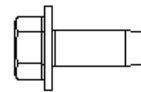

**ITEM 9**  
#14 x ¾ Hex Head SDS  
(1) REQ'D

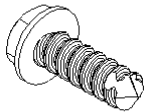

**ITEM 10**  
¼ TURN SPRING LOADED  
(2) REQ'D

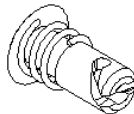

**ITEM 11**  
¼ TURN RETAINER  
(2) REQ'D

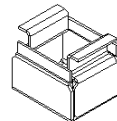

#### **STEP 1: HANG BENCHES ON UNI-STRUT**

Once both benches are hanging on the uni-strut slide the two together until the tops touch. NOTE: IF YOU DO NOT HAVE A CENTER BASE SHELF THEN GO TO STEP 3. Bolt the center base shelf (Item 2) into position using (4) ¼-20 x 5/8 hx hd screw (Item 7), (8) ¼ flat washer (Item 5), & (4) ¼-20 keps nuts (Item 6). DO NOT TIGHTEN.

**STEP 2:** 24" FRONT FACE BRACKET

Insert the (2) ¼ turn retainers (Item 11) into the square holes in the 24" front face bracket. See (Figure 11). Next fasten 24" front face brkt using (4) ¼-20 x ¾ hex head SFS (Item 8) into position, DO NOT TIGHTEN.

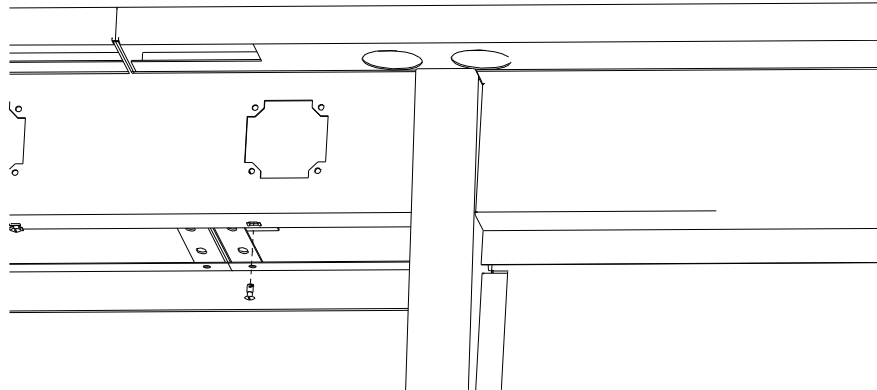

**Figure 11.**

**STEP 3:** TIGHTEN BENCHES

Tighten the (4) 3/8-16 x 1-1/4 hex head bolts that go to the uni-strut on both units. STOP HERE IF YOU DO NOT HAVE A CENTER BASE SHELF. Then tighten the (4) ¼-20 x 5/8 hex head bolts (Item 7) that go to the center base shelf. Also tighten the (4) ¼-20 x ¾ hex head SFS (Item 8) that hold the 24" front face. Lastly install (1) #14-3/4 Hex Head SDS (Item 9), in the front face going up through hole in front flange.

**STEP 4:** INSTALL CENTER DOOR

To install center door drop taps of door into slots in the shelf. Line up the holes in the door with the ¼ turn retainers (Item 11) and then install (2) ¼ turn spring loaded fasteners (Item 10) to hold door. See (Figure 12)

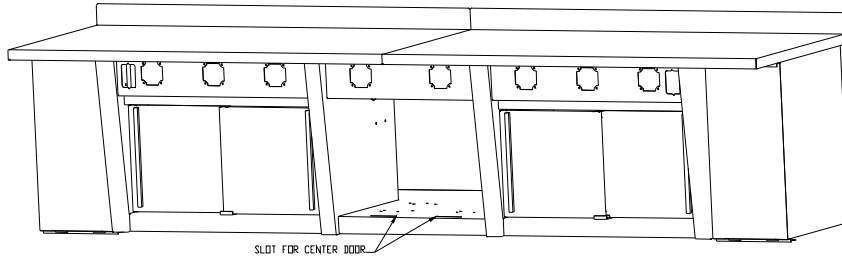

**Figure 12.**

**GO TO SECTION #1, STEP #7**

**\*NOTICE\***

The following is the only warranty applicable to the products: the manufacturer warrants that the products are free from defects in material or workmanship when installed, used and serviced in accordance with the manufacturer's recommendations. The manufacturer's only obligation under this warranty shall be to replace any product, which is defective in materials within one year or defective in workmanship within ninety days, from the date of installation. **THE FOREGOING WARRANTY IS EXPRESSLY IN LIEU OF ALL OTHER WARRANTIES, EXPRESS OR IMPLIED, INCLUDING ANY WARRANTIES OF MERCHANTABILITY OR FITNESS FOR PURPOSE.** The manufacturer shall not be liable for any loss or damage, direct or indirect, resulting from the use or loss of use of the product. This warranty may not be changed except by a written agreement signed by an officer of the manufacturer.

